



Flat 5, Chine Farm Place Main Road, Knockholt, Kent, TN14 7LG

Welcome to this charming property located on Main Road in the picturesque village of Knockholt. This delightful flat boasts a spacious 1,109 sq ft of living space, featuring 1 reception room, 2 bedrooms, and 2 bathrooms.

Situated in a purpose-built development, this property offers a secure and private environment with gated access, providing peace of mind for residents. The stunning views surrounding the property add to its appeal, offering a tranquil and scenic setting for you to enjoy.

Whether you're looking for a cozy home or a peaceful retreat, this property has the potential to cater to your needs. Don't miss out on the opportunity to make this lovely flat your own and experience the beauty of Knockholt living.

- Village location
- Semi - rural position
- Stunning views
- Private parking
- Gated development
- 2 double bedrooms
- 2 x En-suite
- Walk in wardrobe to master bedroom
- Council Tax F
- EPC - B

£2,100 Per Month

FIRST FLOOR
1131 sq.ft. (105.1 sq.m.) approx.

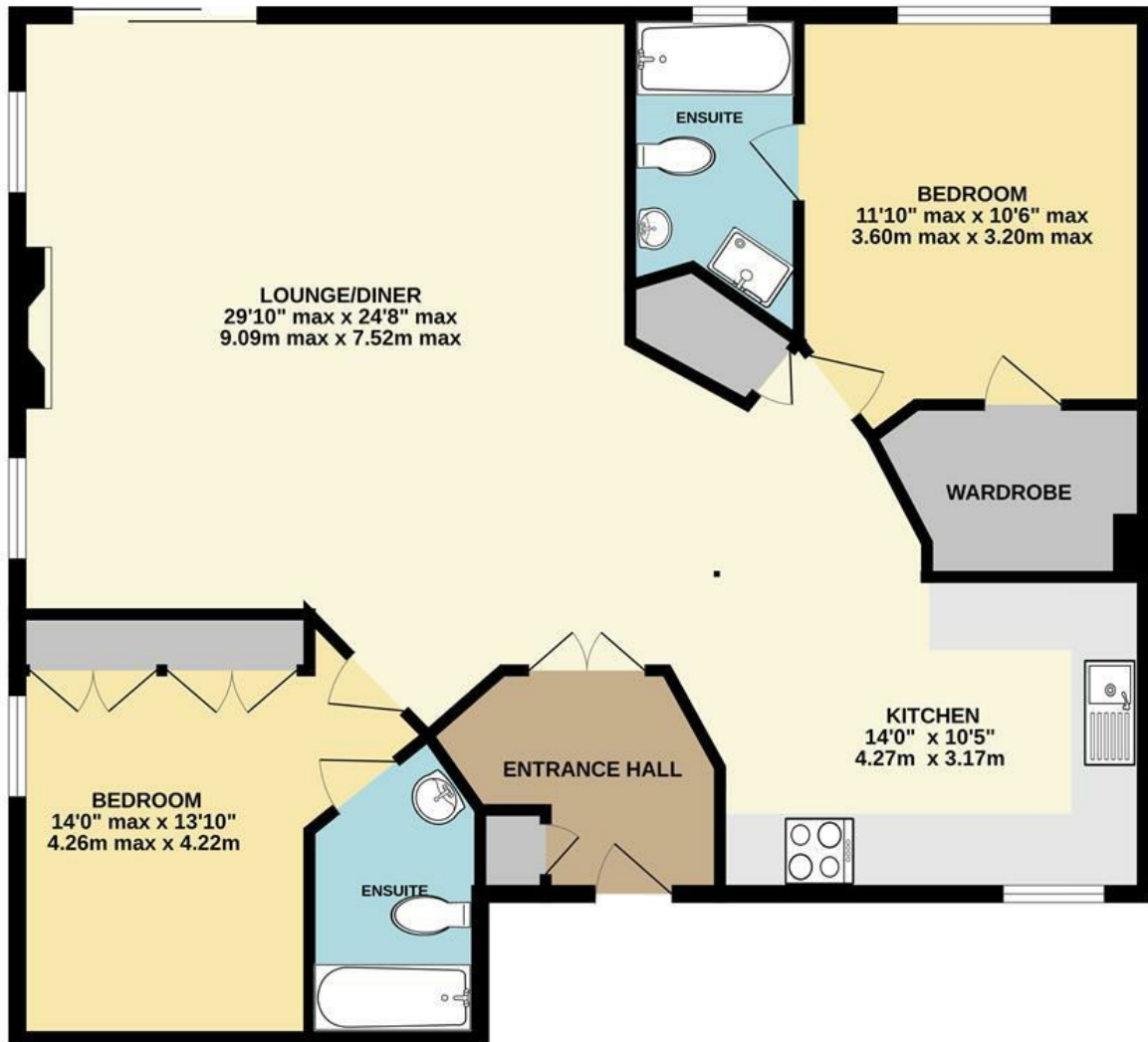

TOTAL FLOOR AREA : 1131 sq.ft. (105.1 sq.m.) approx.

Whilst every attempt has been made to ensure the accuracy of the floorplan contained here, measurements of doors, windows, rooms and any other items are approximate and no responsibility is taken for any error, omission or mis-statement. This plan is for illustrative purposes only and should be used as such by any prospective purchaser. The services, systems and appliances shown have not been tested and no guarantee as to their operability or efficiency can be given.
Made with Metropix ©2024

Energy Efficiency Rating		
	Current	Potential
Very energy efficient - lower running costs		
(92 plus) A		
(81-91) B	82	84
(69-80) C		
(55-68) D		
(39-54) E		
(21-38) F		
(1-20) G		
Not energy efficient - higher running costs		
England & Wales	EU Directive 2002/91/EC 